

# WOHNPARK LANDEGG

Badener Straße 49, 2486 Landegg Pottendorf

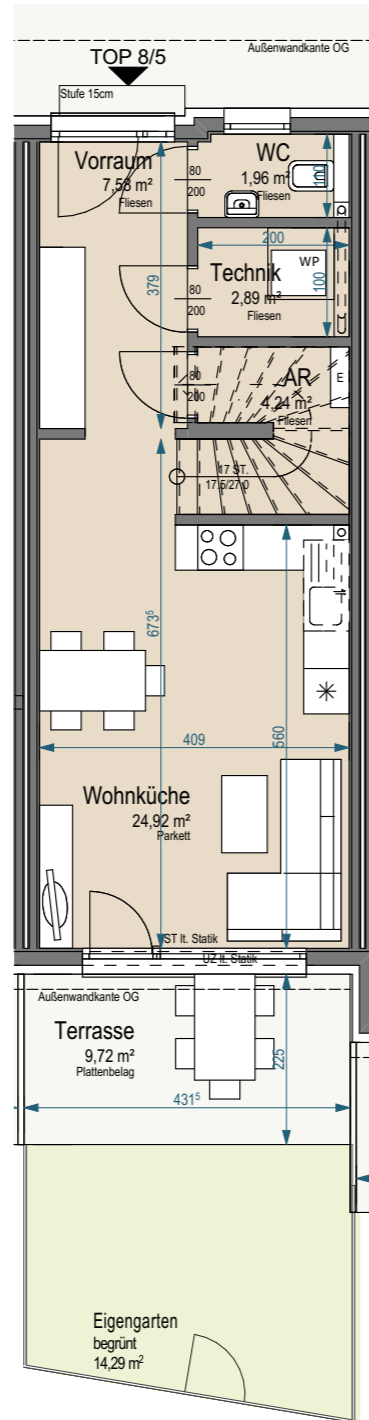

ERDGESCHOSS

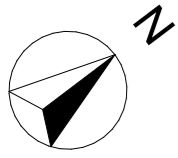
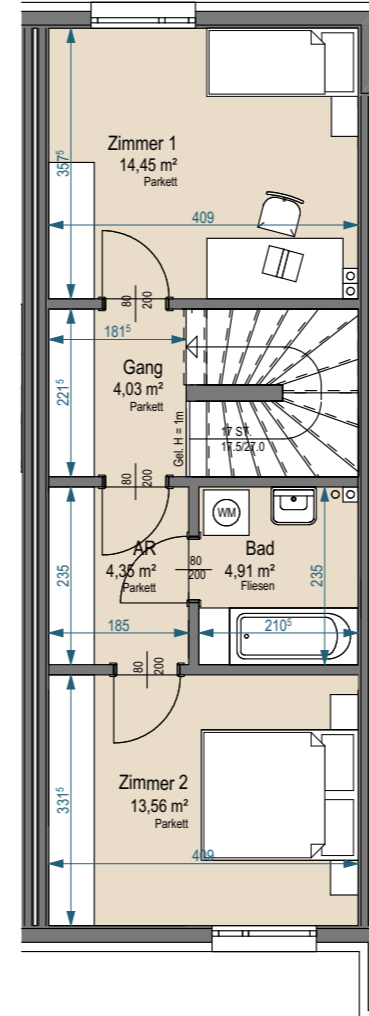

1. OBERGESCHOSS

## TOP 8/5

Wohnfläche	(100%)	82,90 m <sup>2</sup>
Loggia	(100%)	
<b>Wohnnutzfläche</b>		<b>82,90 m<sup>2</sup></b>
Keller	(30%)	
Balkon	(50%)	
Terrasse(n)	(50%)	9,72 m <sup>2</sup>
Garten (+Vorgarten)	(10%)	14,29 m <sup>2</sup>
<b>WNF-gewichtet</b>		<b>89,19 m<sup>2</sup></b>

Geschosse	2
Raumhöhe	2,50m
Zimmerzahl	3
Parkplatznummer	36

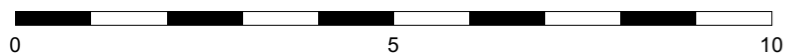

Maßstab 1:100 bei Ausdruck in A3  
Planstand: 09.09.2024